

## WALL AT CORNER WITH EXT. INSUL'N + VERTICAL SIDING - PLAN VIEW

**NOTE:** Both starter strips + rain screen clips are to be hard fastened to wall. Vertical siding installation begins with 2 starter strips back to back at centre of wall with siding continuing outward in both directions. Rain screen clips are recommended to be installed every 32" o/c. Diagonal furring strips fastened to wall studs are recommended to allow for ventilation and structural stability, as well as flexibility in allowing siding installation in any direction. Pieces of siding entering finishing strips are to be ripped along the top to allow for proper insertion into trim piece.

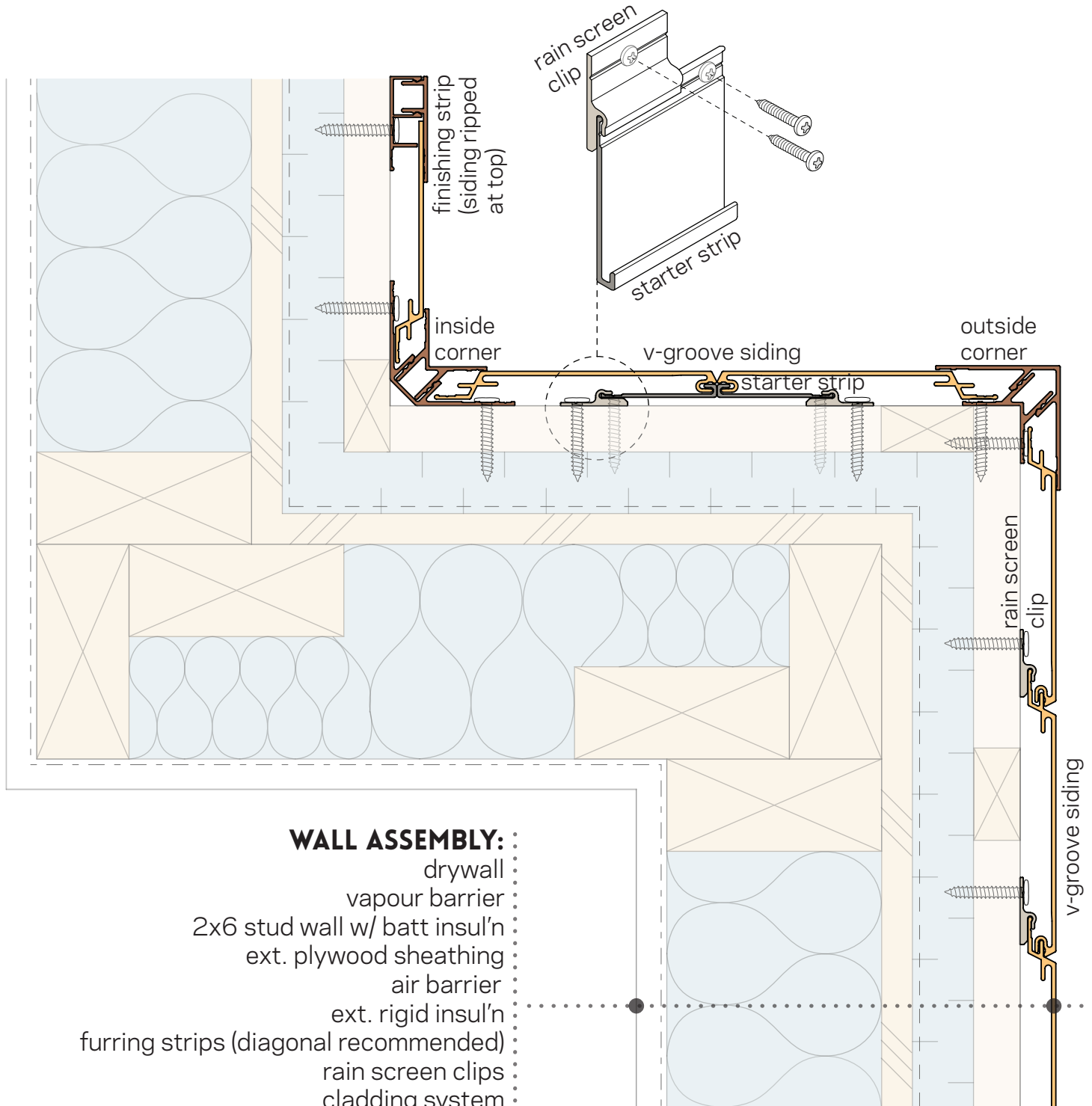

**WALL ASSEMBLY:**

- drywall
- vapour barrier
- 2x6 stud wall w/ batt insul'n
- ext. plywood sheathing
- air barrier
- ext. rigid insul'n
- furring strips (diagonal recommended)
- rain screen clips
- cladding system