

WALL AT WINDOW WITH EXT. INSUL'N + HORIZONTAL SIDING - PLAN VIEW

NOTE: Both starter strips + rain screen clips are to be hard fastened to wall. Horizontal siding installation begins with 1 starter strip at bottom of wall with siding continuing upward. Rain screen clips are recommended to be installed every 32" o/c. Diagonal furring strips fastened to wall studs are recommended to allow for ventilation and structural stability, as well as flexibility in allowing siding installation in any direction.

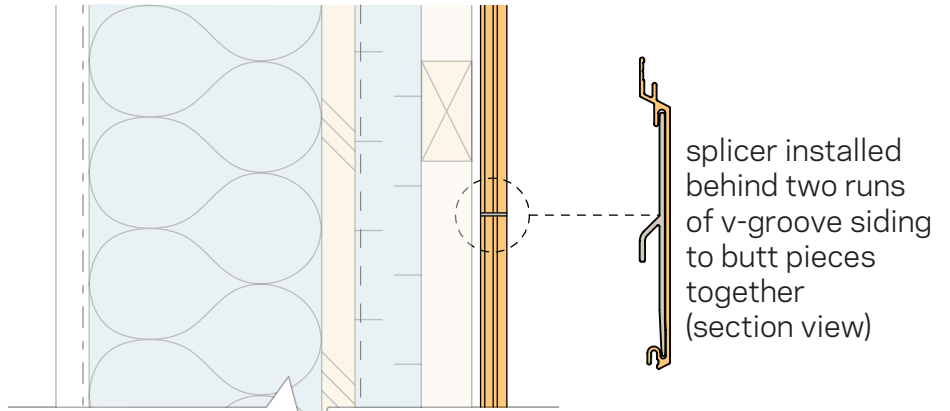

- WALL ASSEMBLY:**
- drywall
 - vapour barrier
 - 2x6 stud wall w/ batt insul'n
 - ext. plywood sheathing
 - air barrier
 - ext. rigid insul'n
 - furring strips (diagonal recommended)
 - rain screen clips
 - cladding system

